



PRO

GTA50W

Robert Bosch Power Tools GmbH
70538 Stuttgart
GERMANY

www.bosch-pt.com

1 609 92A D66 (2025.11) PS / 19



1 609 92A D66

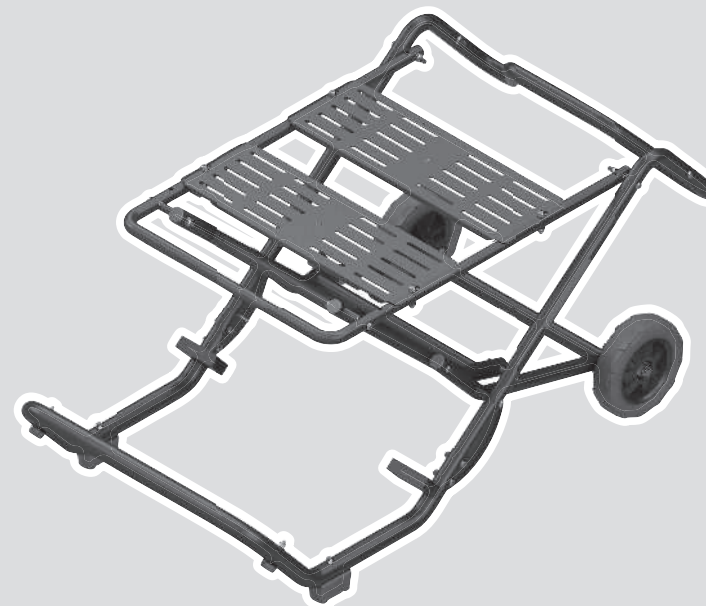

en Original instructions





**GTS 10 XC
GTS100-254
EXTS100-254X**



**GTS 10 J
GTS 70-216
GTS 635-216
GTS 18V-70
GTS 18V-216**



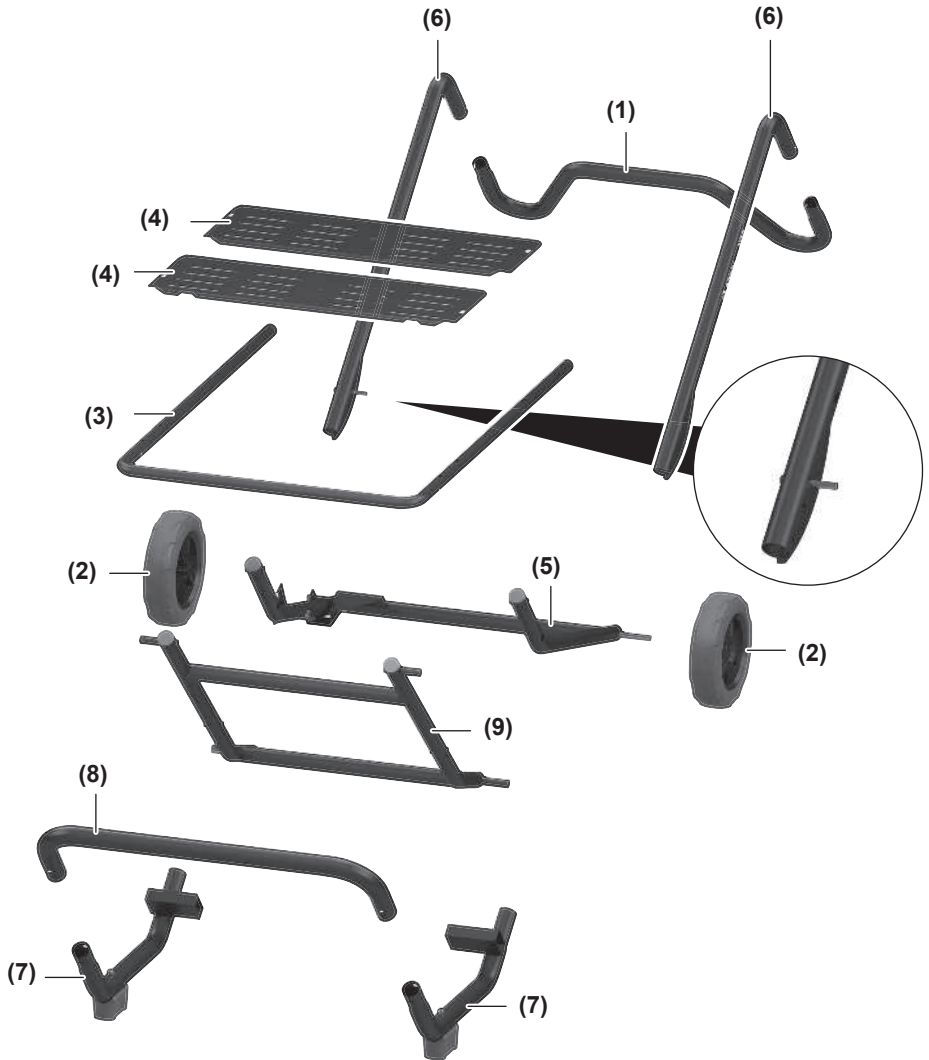



GTS 10 XC



GTS 70-216
GTS 18V-70



GTS 10 J
GTS 635-216
GTS 18V-216



GTS100-254
EXTS100-254X

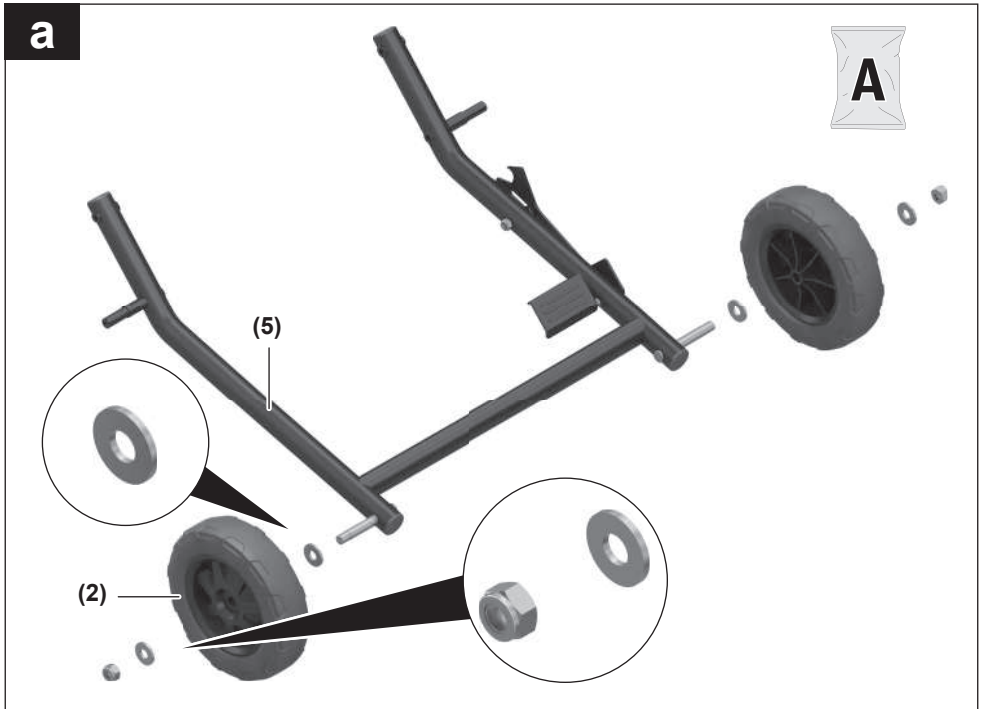

a**b**

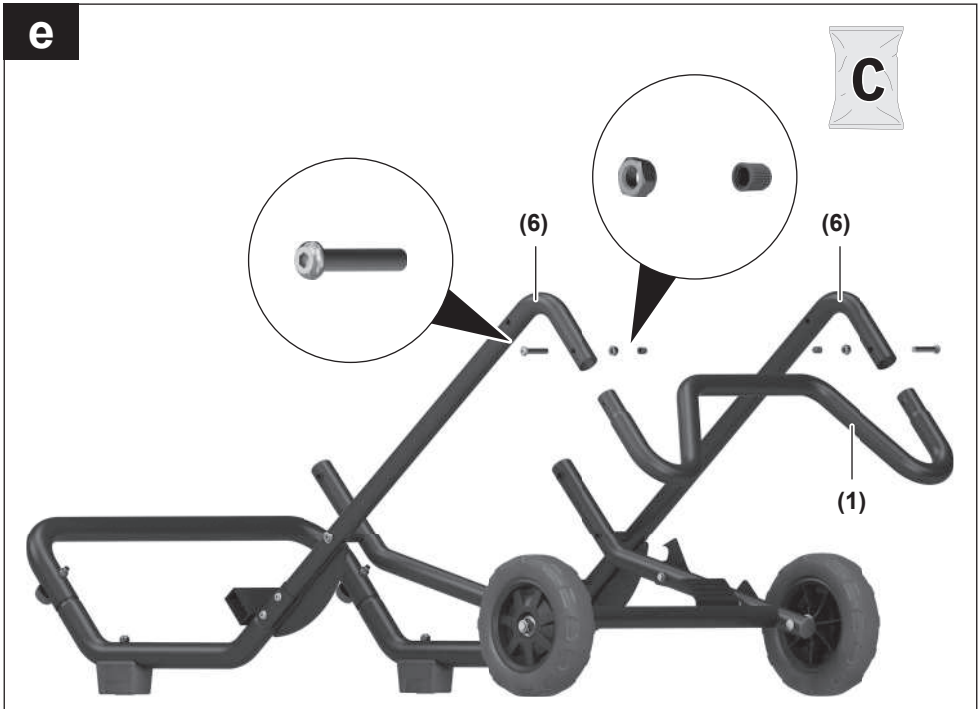

e**f**



i

GTS 70-216
GTS 18V-70
GTS 10 J

GTS 635-216
GTS 18V-216

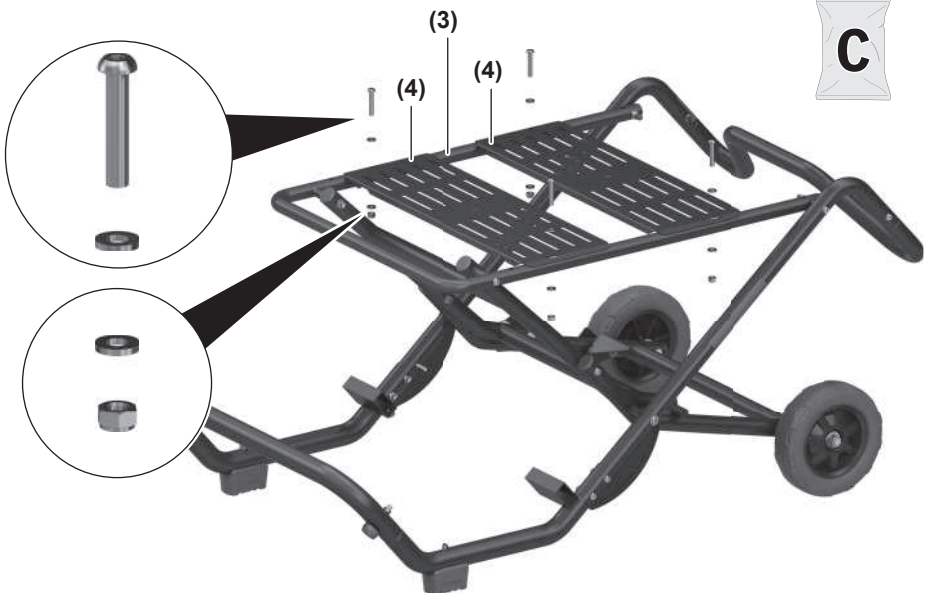
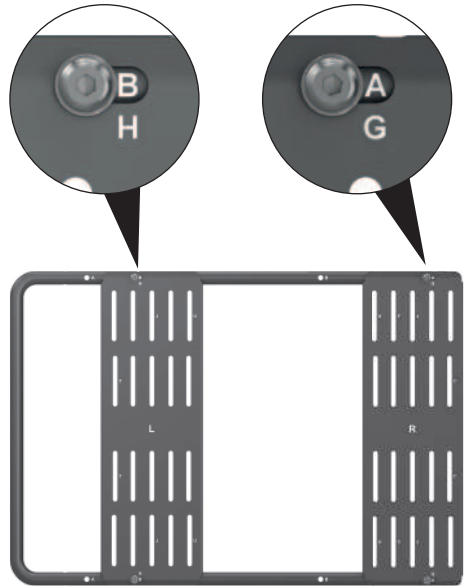
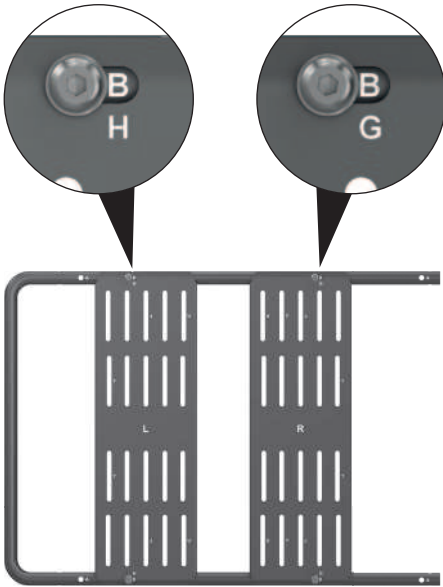

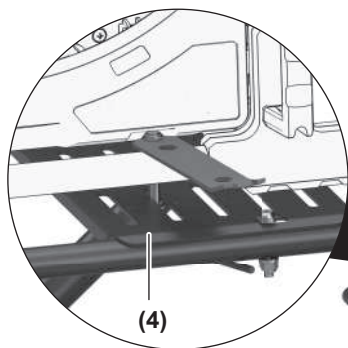
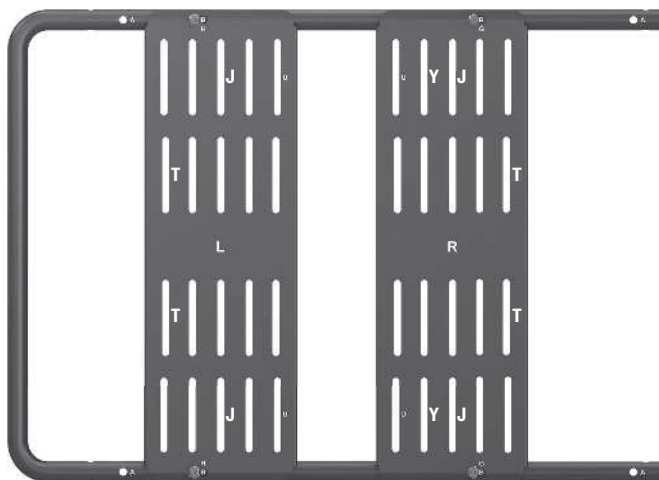
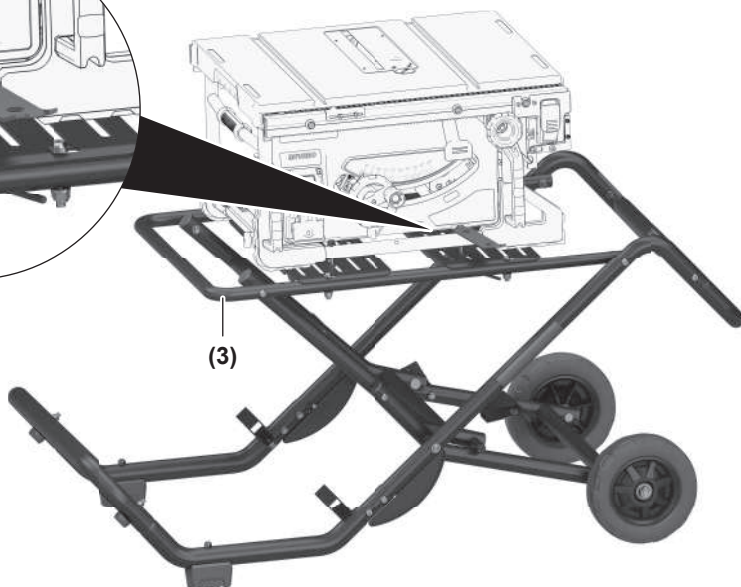
A**(4)****(3)**

B

C1**C2****C3**

English

Safety Instructions

General Safety Instructions



Read all the warnings and instructions included with the saw stand or the power tool you intend to mount on it. Failure to observe the safety and general instructions may result in electric shock, fire and/or serious injury.

Safety Instructions for Saw Stands

- ▶ **Disconnect the plug from the power source and/or remove the battery from the power tool before making any adjustments to the power tool or changing accessories.** Accidents can occur when power tools are started unintentionally.
- ▶ **Assemble the saw stand properly before mounting the power tool.** Correct assembly is important to prevent the risk of collapsing.
- ▶ **Firmly secure the power tool to the saw stand before using it.** You may lose control of the power tool if it slips on the saw stand.
- ▶ **Place the saw stand on a firm, flat, horizontal surface.** If there is a chance that the saw stand will slip or wobble, the safe and steady machining of the workpiece cannot be guaranteed.
- ▶ **Do not overload the saw stand or climb or stand on it.** Overloading or standing on the saw stand can raise its centre of gravity, causing it to tip over.
- ▶ **Ensure that all screws and connecting pieces are tightly fastened during transport and when carrying out work.** Loose connections can cause instability and inaccurate sawing.
- ▶ **Only install and remove the power tool when it is in the transport position (for information on the transport position, also refer to the operating instructions for the relevant power tool).** Otherwise the power tool may have an such unfavourable centre of gravity that you will not be able to hold onto it securely.
- ▶ **Operate the power tool secured to the mounting plate on the saw stand only.** Without the saw stand, the mounting plate with the power tool will not be stable and can tip over.
- ▶ **Ensure that long and heavy workpieces do not unbalance the saw stand.** The free end of long and heavy workpieces must have something placed underneath it or be supported.
- ▶ **When pushing together or pulling apart the saw stand, do not put your fingers near the points of articulation.** There is a risk of fingers being crushed.

Symbols

The following symbols may provide you with important information about the use of your saw stand. Please take note of these symbols and their meaning. Knowing what these symbols mean will help you to use your saw stand more effectively and more safely.

Symbols and their meaning



The maximum load bearing capacity (power tool + workpiece) of the saw stand is **180 kg**.

Product description and specifications

Intended Use

The saw stand is intended for holding the following Bosch benchtop saws (stand **2025/07**):

Without mounting plate:

- GTS 10 XC (3 601 L30 4..)
- GTS100-254 (3 601 M30 7..)
- EXTS100-254X (3 601 M30 8..)

With mounting plate:

- GTS 10 J (3 601 M30 5..)
- GTS 70-216 (3 601 M30 6..)
- GTS 635-216 (3 601 M42 0..)
- GTS 18V-70 (3 601 M44 1..)
- GTS 18V-216 (3 601 M44 0..)

The saw stand and power tool are intended for cutting boards and profiles.

Product Features

The numbering of the components shown refers to the illustrations on the graphics pages at the beginning of the manual.

- (1) Handle
- (2) Wheel
- (3) Assembly rod
- (4) Mounting plate
- (5) Lower frame
- (6) Linkage bar
- (7) Support rod
- (8) Cross bar
- (9) Upper frame
- (10) Foot pedal
- (11) Locking hook
- (12) Lock bolt
- (13) Foot support

Technical Data

Saw stand		GTA50W
Article number		3 601 M57 0..
Saw stand height	mm	561
Max. load bearing capacity (power tool + workpiece)	kg	180
Weight, approx.		
- without mounting plate	kg	15.5
- with mounting plate	kg	19.5

Assembly

Items included



See the list of items included at the start of the operating manual.

Check to ensure that all the parts listed below have been supplied before assembling the saw stand:

Frame parts

No.	Designation	Quantity
(1)	Handle	1
(2)	Wheel	2
(3)	Assembly rod	1
(4)	Mounting plate	2
(5)	Lower frame	1
(6)	Linkage bar left/right	2
(7)	Support rod left/right	2
(8)	Cross bar	1
(9)	Upper frame	1

Fastening sets for saw stand

Fastening set	Designation/size	Quantity
A	Washer Dia. 30 x dia. 13 x 3 mm	4
	Lock nut M12	2
B	Hex socket screw M8 x 15 mm	2
C	Hex socket screw M8 x 45 mm	10
	Washer Dia. 16 x dia. 8.2 x 2.5 mm	8
	Lock nut M8	10
	Rubber threaded cap	2

Fastening set	Designation/size	Quantity
D	Hex socket screw M8 x 60 mm	2
	Washer Dia. 16 x dia. 8.2 x 1.5 mm	2
	Lock nut M8	2
	Rubber base	2
E	Hex socket screw M8 x 80 mm	4
	Washer Dia. 16 x dia. 8.2 x 2.5 mm	8
	Lock nut M8	4
	Rubber threaded cap	2
F	Hex socket screw M8 x 110 mm	2
	Washer Dia. 16 x dia. 8.2 x 2.5 mm	4
	Lock nut M8	2
G	Hex key	1
	Ring/open-ended spanner	1

Power tool fastening sets

Fastening set	Designation/size	Quantity	
GTS 10 XC	Hex socket screw M8 x 105 mm	4	
	Washer Dia. 16 x dia. 8.2 x 2.5 mm	8	
	Lock nut M8	4	
GTS 70-216	Hex socket screw M6 x 50 mm	4	
GTS 18V-70	Washer Dia. 18 x dia. 6.2 x 1.5 mm	8	
	Lock nut M6	4	
GTS 10 J	Hex socket screw M6 x 45 mm	4	
GTS 18V-216	Washer Dia. 18 x dia. 6.2 x 1.5 mm	8	
	Lock nut M6	4	
GTS100-254 EXTS100-254X	Hex socket screw M8 x 75 mm	4	
	Washer Dia. 16 x dia. 8.2 x 2.5 mm	8	
	Lock nut M8	4	

Assembling the Saw Stand

- Carefully remove all parts included in the delivery from their packaging.
- Remove all packing material.
- For assembly, follow figures a–h.

For figure a:

Fastening set A

- Screw together a wheel (2) to each lower frame (5).
- Turn the wheel. If the wheel cannot be turned freely, release the nut by a 1/8 to a 1/4 turn.

For figure b:

Fastening set B

- Screw both the left-hand and right-hand linkage bars (6) onto the lower frame (5)
- Use the welded sockets for this purpose.

Note: The locking bolt (12) is located on the **right-hand** linkage bar (6).

For figure c:

Fastening set C

- Insert the left-hand linkage bar (6) into the left-hand support rod (7) until they are aligned with the assembly holes.
- Screw both elements together.
- Repeat the steps with the right-hand linkage bar (6) and the right-hand support rod (7).

For figure d:

Fastening set D

- Insert the cross bar (8) onto the left-hand and right-hand support rods (7) until they are flush with the assembly holes.
- Screw the elements together.

For figure e:

Fastening set C

- Insert the handle (1) into the left-hand and right-hand support rods (6) until they are flush with the assembly holes.
- Screw the elements together.
- Screw the rubber threaded caps onto the protruding screw threads to protect your hands against injury in the handle section.

For figure f:

Fastening set E

- Screw together the upper frame (9) and the lower frame (5).
- Tighten the screw connection firmly. Then loosen the nut by a 1/8 or a 1/4 turn.
- Note:** To ensure that the screw connection is not tightened too firmly, it must be possible to freely rotate the centre washer.

For figure g:

Fastening set F

- Screw together the upper frame (9) and the assembly rod (3).
- Tighten the screw connection firmly. Then loosen the nut by a 1/8 or a 1/4 turn.
- Note:** To ensure that the screw connection is not tightened too firmly, it must be possible to freely rotate the centre washer.

For figure h:

Fastening set E

- Screw the assembly rod (3) onto the left-hand and right-hand linkage bar (6).
- Tighten the screw connection firmly. Then loosen the nut by a 1/8 or a 1/4 turn.
- Note:** To ensure that the screw connection is not tightened too firmly, it must be possible to freely rotate the centre washer.
- Screw the rubber threaded caps onto the screw threads to protect your hands against injury in the handle section.

Fitting the Mounting Plates (see figure i)

Fastening set C

- Place the mounting plates (4) on the assembly rod (3).
- L:** Direction of the cross bar (8)
- R:** Direction of the handle (1)

Depending on the model, the elongated holes (H, G) in the mounting plates must be flush with different assembly holes (A, B) in the assembly rod.

Model	Mounting plate L (elongated hole H)	Mounting plate R (elongated hole G)
GTS 70-216 GTS 18V-70 GTS 10 J	Assembly hole B	Assembly hole B
GTS 635-216 GTS 18V-216	Assembly hole B	Assembly hole A

- Screw the elements together as far left as is possible in the elongated hole (direction of the cross bar).

Fastening the Power Tool

Fastening the Power Tool on the Mounting Plates (see figure A)

The mounting plates (4) are suitable for general use. The various different mounting holes allow the following power tools from **Bosch** to be mounted on the saw stand.

Model	Mounting plate L	Mounting plate R
GTS 70-216 GTS 18V-70	J	Y
GTS 10 J	J	J
GTS 635-216 GTS 18V-216	T	T

- Position the power tool in the centre over the corresponding mounting holes.
- Screw together the mounting plate and power tool using the compatible screws, washers and nuts.
- GTS 70-216, GTS 18V-70:** The screw is guided from be-

low through the mounting plates. The nut sits on top of the power tool frame.

Fastening the Power Tool on the Assembly Rod (see figure B)

The assembly rod (3) is suitable for general use. The various different mounting holes allow the following power tools from **Bosch** to be mounted on the saw stand.

Model	Mounting holes
GTS 10 XC	A
GTS100-254 EXTS100-254X	B

- Position the power tool in the centre over the corresponding mounting holes.
- Screw together the assembly rod and power tool using the compatible screws, washers and nuts. When doing so, the screw is guided from above through the power tool frame. The nut sits on the bottom of the assembly rod frame.

Operation

Working Advice

Always hold the workpiece firmly in place, especially long, heavy pieces. Once the workpiece has been cut, the centre of gravity may be displaced, causing the saw stand to tip over.

Do not overload the saw stand. Always observe the maximum load bearing capacity of the saw stand.

Transport and Storage (see figures C1–C3)

You can push together the saw stand for **transporting**.

- Press the foot pedal (10) to release the locking hook (11) from the locking bolt (12).
- Pull the handle (1) upwards with both hands until the locking hook (11) engages again.

Lower the saw stand for **storage**.

- Hold the handle (1) firmly with both hands and place one foot against the foot support (13). Pull back the handle (1) and lower the saw stand onto the ground.

To carry out **work**, you must set up the saw stand again.

- Press the foot pedal (10) to release the locking hook (11) from the locking bolt (12).
- Pull the handle (1) of the saw stand upwards with both hands and press it forwards until it engages in the upright position.

Maintenance and Service

After-Sales Service and Application Service

Great Britain

Tel. Service: (0344) 7360109

GB Importer:

Robert Bosch Ltd.
Broadwater Park
North Orbital Road
Uxbridge
UB9 5HJ

Malaysia

Tel.: (03) 79663194

You can find the link to our service addresses and warranty conditions on the last page.

In all correspondence and spare parts orders, please always include the 10-digit article number given on the nameplate of the product.

Disposal

Saw stands, accessories and packaging should be recycled in an environmentally responsible manner.

Servicekontakte
Service Contacts
Contacts de Service
Contactos de Servicio



<https://www.bosch-pt.com/serviceaddresses>

Garantiebedingungen
Guarantee Conditions
Conditions de Garantie
Condiciones de Garantía



<https://www.bosch-pt.com/guarantee/202507>